

ActualCollection

WELCOME TO ACTUALCOLLECTION

ActualCollection dumps, higher pass rate



ActualCollection is a website offering the latest and valid actual exam dump to make you go through the actual test with a high score.



Quality and Value

ActualCollection Practice Exams are written to the highest standards of technical accuracy, using only certified subject matter experts and published authors for development - no all dumps.



Tested and Approved

We are committed to the process of vendor and third party approvals. We believe professionals and executives alike deserve the confidence of quality coverage these authorizations provide.



Easy to Pass

If you prepare for the exams using our ActualCollection testing engine, it is easy to succeed for all certifications in the first attempt. You don't have to deal with all dumps or any free torrent / rapidshare all stuff.



Try Before Buy

ActualCollection offers free demo of each product. You can check out the interface, question quality and usability of our practice exams before you decide to buy.

<http://www.actualcollection.com>

Actual dumps collection, higher pass rate

Exam : **E20-690**

Title : VNX Solutions Specialist Exam
for Platform Engineers

Vendor : EMC

Version : DEMO

NO.1 When using USM's Capture Diagnostic Data feature, where are the files automatically stored upon completion of this task?

- A. They are in the C:\EMC\repository folder located on the system running USM.
- B. They are automatically uploaded to EMC support if the system is registered.
- C. The user is prompted to either view them or upload them to EMC if ConnectHome is configured.
- D. They are automatically stored in the repository located on the VNX vault drives.

Answer: A

NO.2 How would you discover the appropriate network setting from the computer where the VNX Installation Assistant for File is running?

- A. Choose the "Select to use network settings from this client" option.
- B. Verify the MAC address from the Control Station sticker, and then reboot the Control Station.
- C. Select any other available MAC address to determine the network configuration.
- D. Search DNS for the Control Station's computer name and use the associated network settings.

Answer: A

NO.3 The service engineer tries to modify ConnectHome settings in Unisphere but all attempts fail. What is the reason for the failure?

- A. User has root privileges.
- B. User does not have root privileges.
- C. User is not logged in as nasadmin.
- D. User is not logged in as sysadmin.

Answer: B

NO.4 Which worksheet can be used to collect data about operating environmental requirements for a VNX Gateway installation?

- A. Site Preparation
- B. Control Station Networking
- C. Various Configuration
- D. Private LAN

Answer: A

NO.5 You are onsite for a DAE and drive upgrade for a VNX 5800 array. After inspecting the collections from the array you notice that the VNX has the following active configuration: 1 x 2.5" DPE 21 x 2.5" DAE's 10 x 3.5" DAE's 681 bound data and hotspare drives 0 faulted drives 2 unbound drives How many additional 2.5" DAEs and drives can the array support?

- A. 2 x 2.5" DAEs, 67 drives
- B. 2 x 2.5" DAEs, 76 drives
- C. 4 x 2.5" DAEs, 67 drives
- D. 4 x 2.5" DAEs, 76 drives

Answer: A

NO.6 What does UDoctor analyze to determine if an alert needs to be dialed home to EMC?

- A. Event XML file
- B. SPCollect files
- C. Array Configuration Report
- D. Array Issues Summary

Answer: A

NO.7 Refer to the exhibit.

```
Encryption Enabled          = no

Dial In :
  Enabled                   = yes
  Modem phone number       =
  Site ID                   = 2639
  Serial number            = APM00111701395

Email :
  Priority                   = Disabled
  Sender Address            = connectemc@emc.com
  Recipient Address(es)    = emailalert@emc.com
  Subject                   = CallHome Alert
  Primary :
    Email Server            =
    Email IP Protocol      = IPv4
  Secondary :
    Email Server            =
    Email IP Protocol      = IPv4

FTP :
  Priority                   = 1
  Primary :
    FTP Server              = 10.5.21.10
    FTP Port                 = 21
    FTP User Name           = onalert
    FTP Password            = *****
    FTP Remote Folder      = incoming
    FTP Transfer Mode       = passive
    FTP IP Protocol         = IPv4
  Secondary :
    FTP Server              =
    FTP Port                 = 21
    FTP User Name           = onalert
    FTP Password            = *****
    FTP Remote Folder      = incoming
    FTP Transfer Mode       = passive
    FTP IP Protocol         = IPv4

Modem :
  Priority                   = Disabled
  Primary :
    Phone Number            = 918005270941
  Secondary :
    Phone Number            = 918006262452

HTTPS :
  Priority                   = Disabled
  URL                       =
  HTTPS IP Protocol         =
  Private Key File          = /nas/opt/connectemc/certs/https-privatekey.pem
  Private Key Passphrase    = *****
  Client Certificate        = /nas/opt/connectemc/certs/https-cert.pem
  Server CA Bundle         = /nas/opt/connectemc/certs/https-ca-cert.pem
  Verify Server Name        = no
```

Which command was used to generate this output?

- A. /nas/sbin/connectemc
- B. nas_emailuser
- C. /nas/sbin/nas_connecthome
- D. /nas/sbin/modemtst

Answer: C

NO.8 What is a function of the ESRS Management Utility?

- A. Adds VNX Block system to the centralized monitoring agent
- B. Applies the latest call home template to the Control Station
- C. Automatically adds all arrays in the domain
- D. Adds and approves Storage Processors A and B in Powerlink

Answer: A

NO.9 Which describes the VNX Control Volumes?

- A. Private system LUNs where the EMC NAS code is installed
- B. Control LUNs that the Unisphere Host Agent uses to manage the array
- C. Volumes that AVM manages and that store NAS file systems
- D. Partitions containing the VNX OE for Block operating system

Answer: A

NO.10 You are onsite to replace a faulted Data Mover. After the faulted Data Mover has been physically replaced, which command will return the primary Data Mover back to an active state?

- A. server_standby < movername> -restore mover
- B. server_standby < movername> - activate mover
- C. server_setup < movername> -load mover
- D. server_setup < movername> -start mover

Answer: A

NO.11 Refer to the exhibit.

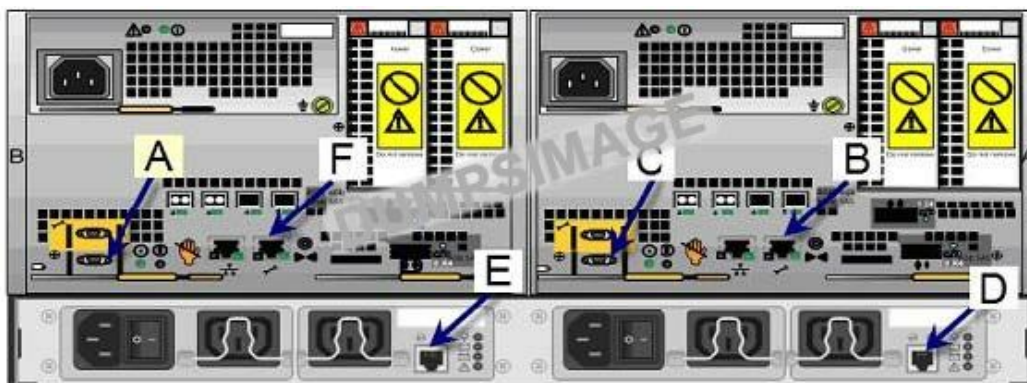

A service engineer needs to collect logs from SP B due to an unscheduled reboot. Which letter indicates the location where the service engineer would connect to SP B?

- A. F
- B. B
- C. E
- D. C

Answer: A

NO.12 Which is a requirement for configuring a primary and standby Data Mover for failover

operation?

- A. Highest server_# used for standby
- B. Identical I/O modules
- C. Four-port network adapter
- D. One standby Data Mover (DM) per primary DM

Answer: B

NO.13 What is the default VNX Unified storage system name?

- A. Array serial number
- B. ImageA and ImageB
- C. Control Station name
- D. Array model number

Answer: A

NO.14 Which protocols does the Storage System Initialization Wizard use to discover an uninitialized VNX?

- A. UDP broadcasts and UDP multicasts
- B. TCP broadcasts and UDP multicasts
- C. TCP broadcasts and TCP multicasts
- D. UDP broadcasts and TCP multicasts

Answer: A

NO.15 What does a green LED blinking at a constant rate indicate on a 3.5" disk drive?

- A. The drive is spinning up or down.
- B. The drive is performing self-diagnostics.
- C. The drive has I/O activity.
- D. Drive enclosure power is applied but the controller enclosure is down.

Answer: A